

VOLVO

Service Manual

Fault tracing

Repairs

Maintenance

Section 2 (25, 26, 27)

B200, B230 Engines

740/760 1985-19..



Tightening torques

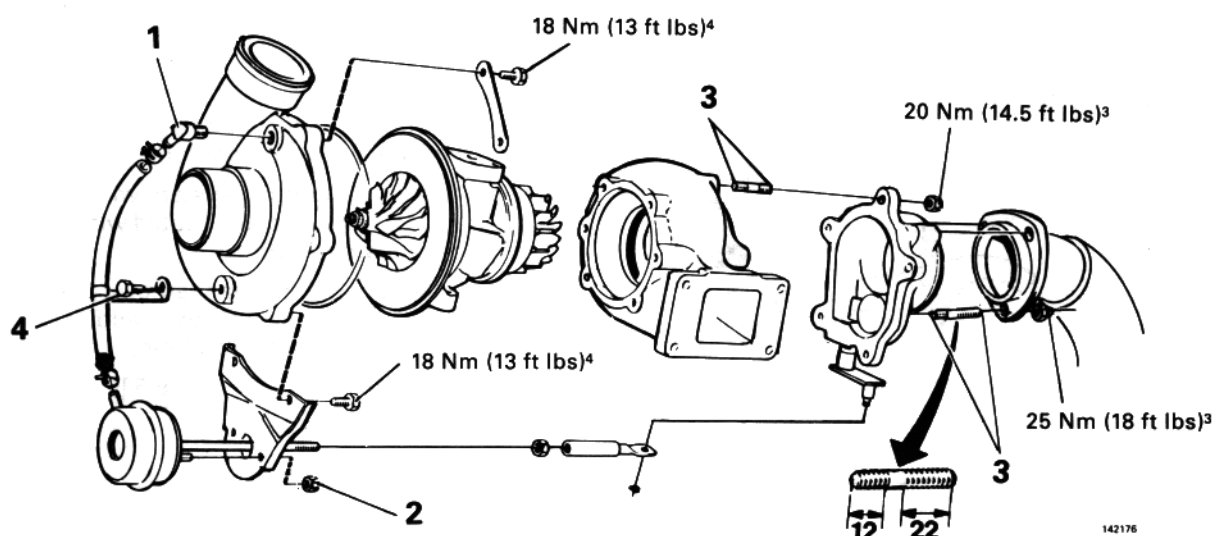

- ¹ Use sealer (P/N 1 161 053-2)
² Use new nuts
³ Use "never seez" (P/N 1 161 035-9)
⁴ Use new bolts. The old bolts may be reused if necessary if they are coated with sealer (P/N 1 161 053-2)

Retaining nuts, turbocharger to manifold:

- Measure length of bolt, replace bolts if necessary. Bolts may be used provided they are no longer than **89 mm (3.50 in.)**.
- Lubricate threads and contact surfaces of bolts with assembly paste 1161078-9.
- Install a **new** securing plate.
- Tighten bolts in three stages according to illustration.

Stage I = 1 Nm (9 in lb)
 II = 45 Nm (33 ft lb)
 III = 45° in one movement

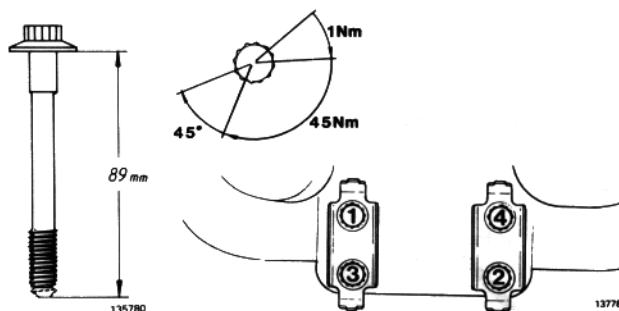

A. Intake manifold

Removal

A1

Drain coolant

Level must be below intake manifold.

A2

Remove intake manifold

A-engines

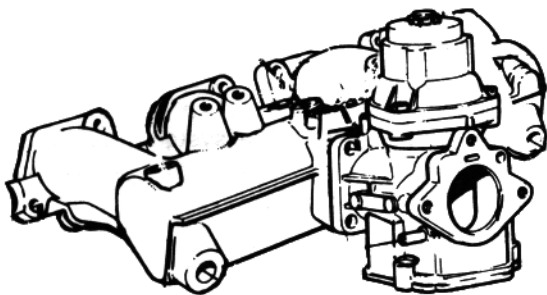

142284

K-engines

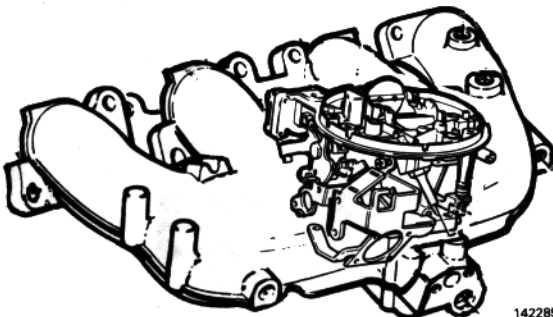

142285

ET/FT-engines

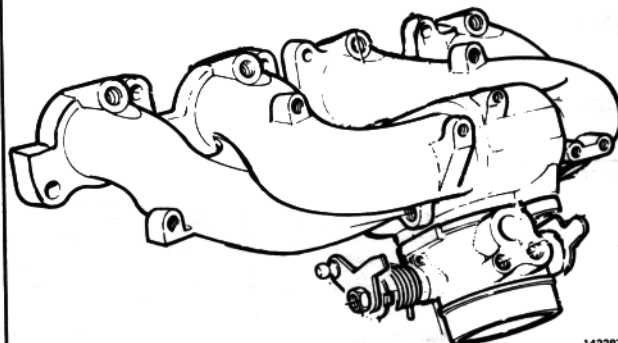

142287

E-engines

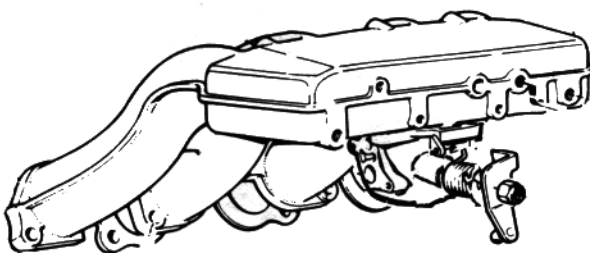

142286

F-engines

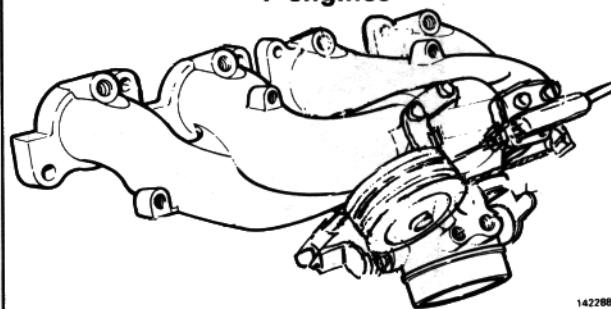

142288

AN. Cruise control

AN1

Component locations

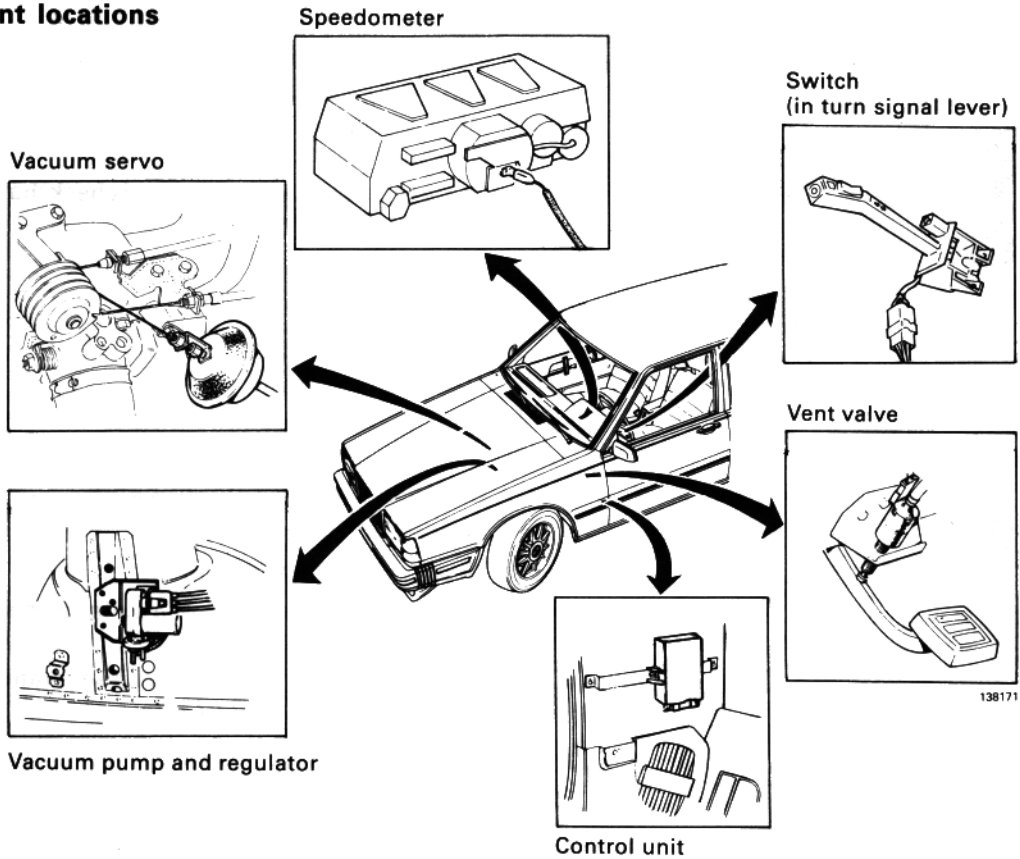

Wiring diagram

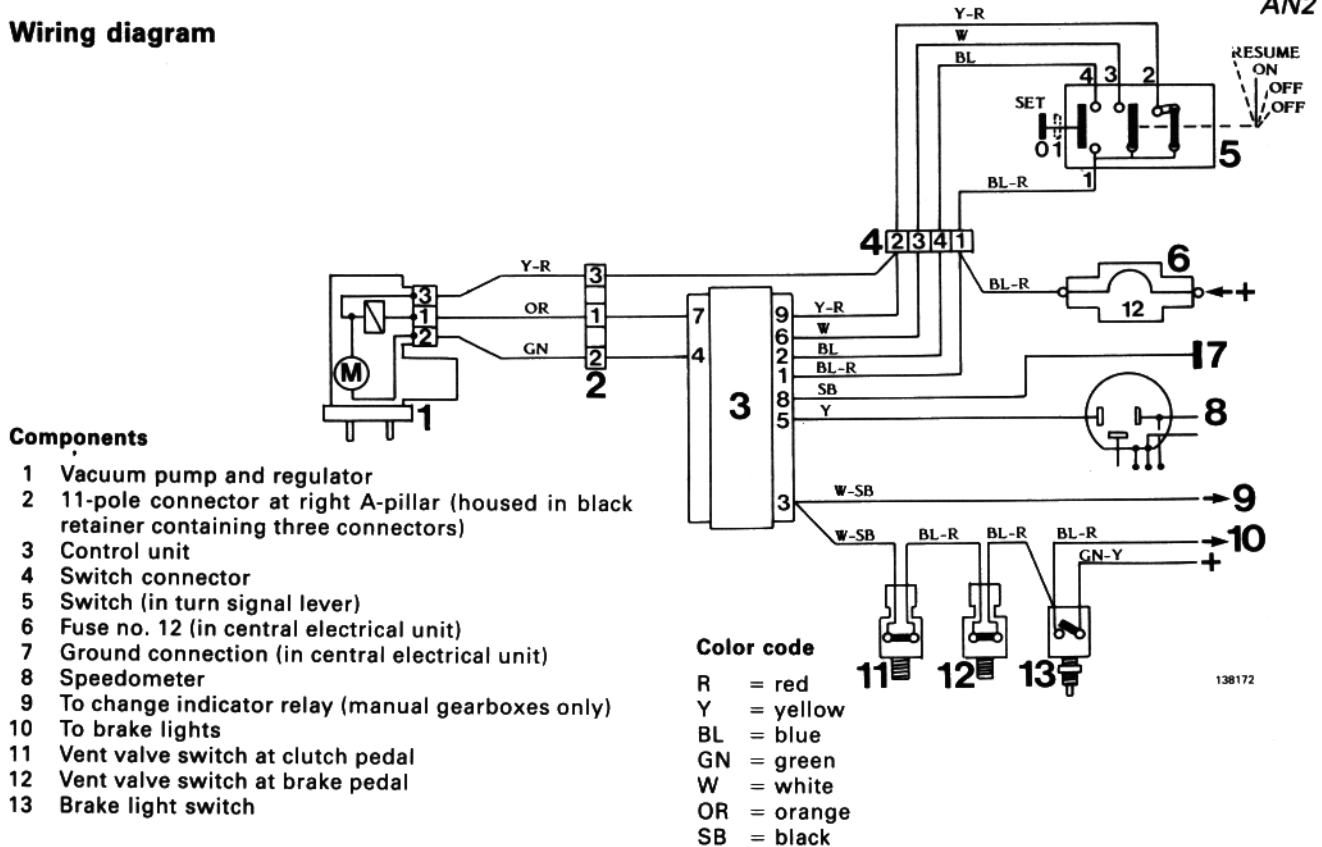

Components

- 1 Vacuum pump and regulator
- 2 11-pole connector at right A-pillar (housed in black retainer containing three connectors)
- 3 Control unit
- 4 Switch connector
- 5 Switch (in turn signal lever)
- 6 Fuse no. 12 (in central electrical unit)
- 7 Ground connection (in central electrical unit)
- 8 Speedometer
- 9 To change indicator relay (manual gearboxes only)
- 10 To brake lights
- 11 Vent valve switch at clutch pedal
- 12 Vent valve switch at brake pedal
- 13 Brake light switch

Test procedures	Fault symptoms	Cause/Remedy
<ul style="list-style-type: none"> • Ignition ON • Switch in ON position Connect test lamp between ground and terminal 6. Move switch to RESUME position. Lamp should light .	Lamp does not light	– check switch, see A08 – break in wiring
<ul style="list-style-type: none"> • Ignition ON • Switch in ON position Connect a wire between ground and terminal 7. A click should be heard from vacuum pump in engine compartment. Connect another wire between ground and terminal 4. Vacuum pump should start.	No click heard or pump does not start	– break in wiring – faulty pump

A08

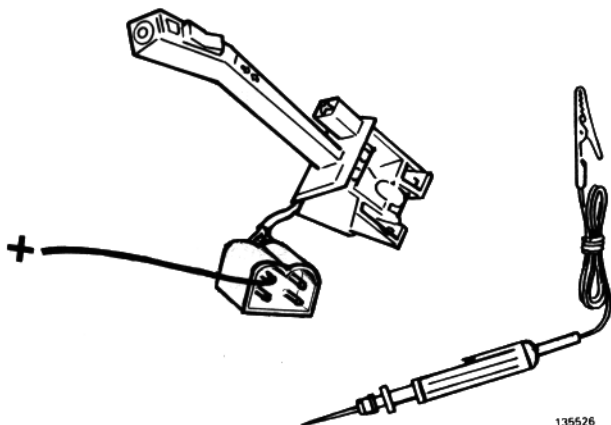
**Check of cruise control switch**

Separate connector at cruise control switch.

Connect a wire from a current supply (12V) to connector terminal 1.

Connect a test lamp between ground and the three other terminals in order from 2 to 4.

Lamp should light according to the table below. Replace cruise control switch if defective.

Terminal	Cruise control switch position and lamp function			
	OFF	ON	ON SET SPEED pushed	RESUME
2	off	ON	ON	ON
3	off	off	off	ON
4	off	off	ON	off

