

Replacing heat exchanger

Information

A new and larger type of heater unit was introduced during the production of model 1992. Only the new type of heater unit will be stocked as a replacement part. When replacing heater unit of earlier type with the new, larger type the partition section of the heater unit housing must be modified (made larger) to make room for the new heater unit type.

Preparations

Unlike the evaporator, the heater unit and climate control unit are replaced working in the car.

- Apply hose clamps to heater unit hoses in engine compartment.

F1

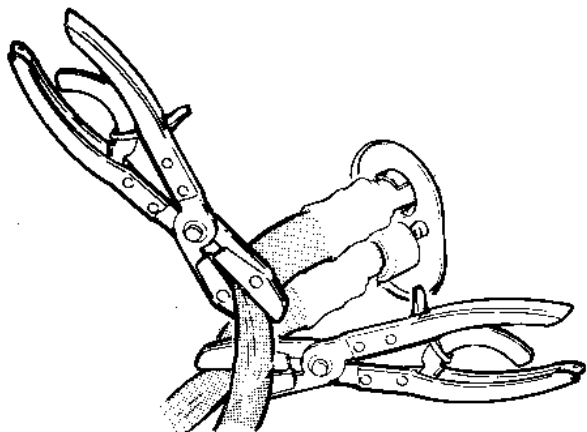

F2

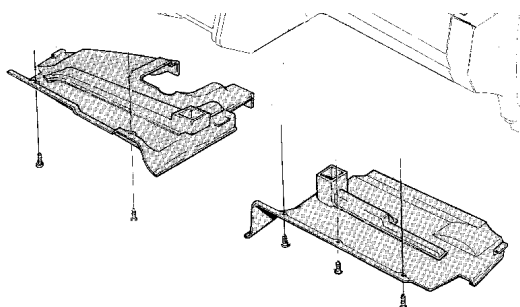

F4

F3

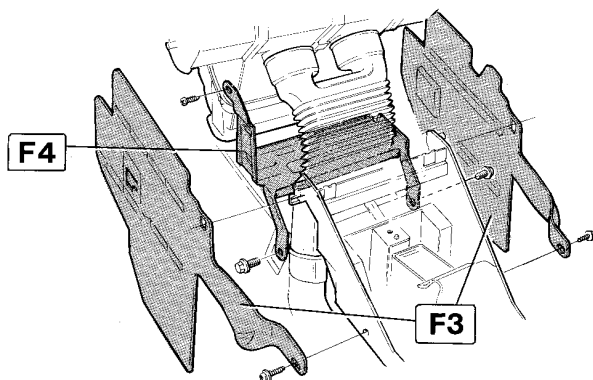

Removal

- Remove left and right soundproofing panels

- Remove floor carpet support plates.
First bend carpet down on both sides.
- Remove the booster/amplifier bracket
First remove the booster/amplifier if installed.

- Remove the drain hose.
- Undo screws (4 screws) to the heater unit cover.
- The illustration on left shows the left side two screws, the screws for the right side are similarly located.
- Undo the heater unit pipe flange screws.
- **Note!** First put plenty of absorbent paper under the flange to catch any coolant that runs out.

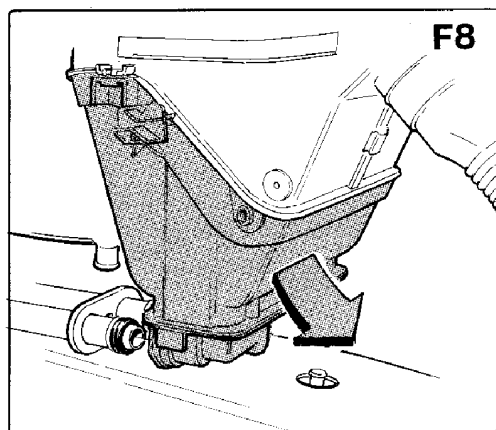
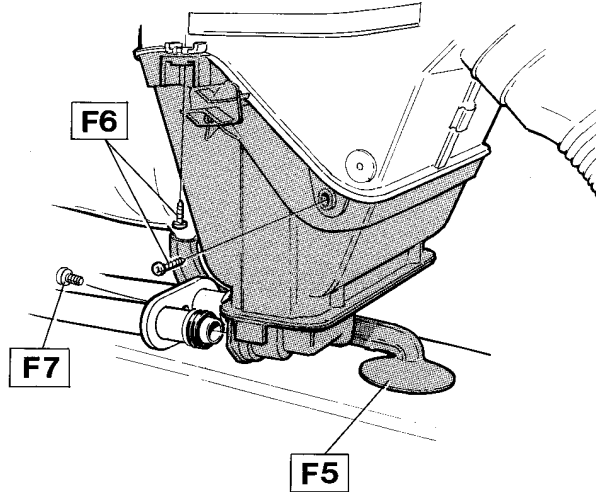

- Remove heater unit with cover
- Begin by detaching the pipes from the heater unit. Then detach the heater unit and cover by pulling to the rear toward the gear selector lever and twisting them slightly up at the same time. When the heater unit is free of the upper part of the climate control system it can be removed to the side.

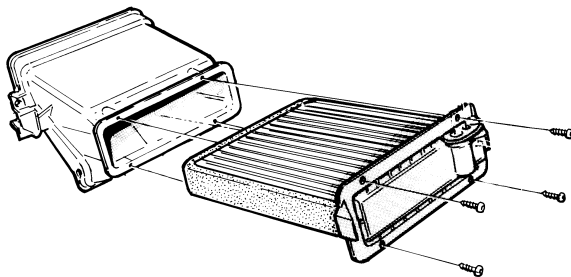

Removing heater unit from cover:

- Undo the screws (4 screws) on the bottom of the heater unit.

Splashguard under engine (earlier models)

This apply only to cars with chassis numbers 000001–002345.

The flange is located at the top of the central element. It is held in place with a snap fastening and can be easily removed by hand. Discard the flange (scrap material).

Pos. 1= Flange.

Pos. 2= Central element.

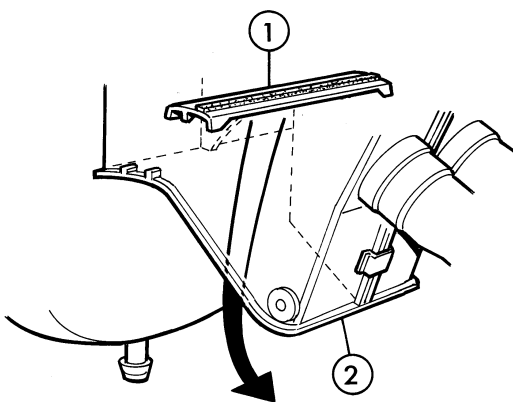

Cut away material from the partition in the central element. Cut away as illustrated. Use a knife, scissors or pliers. Try the new heater unit to see if there is sufficient room.

A=11mm.

B=3-5mm.

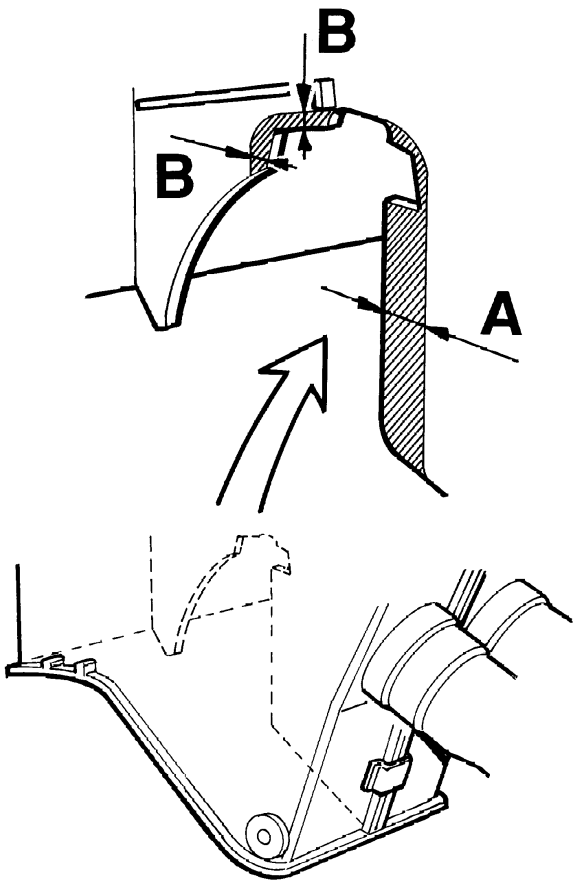

Connect the new pipes to the quick-release connectors on the firewall. Replace O rings and reinstall couplings which were on the old pipes when removed.

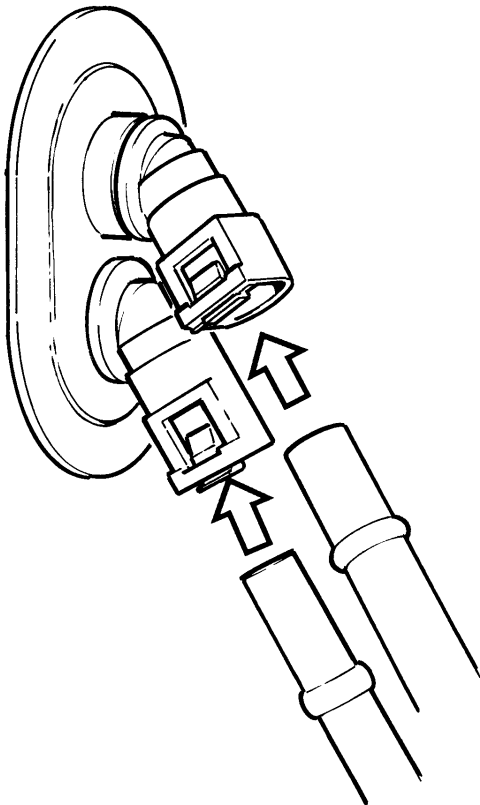

Remove screws securing the quick-release connector in the engine compartment. This makes the operations that follow easier to carry out.

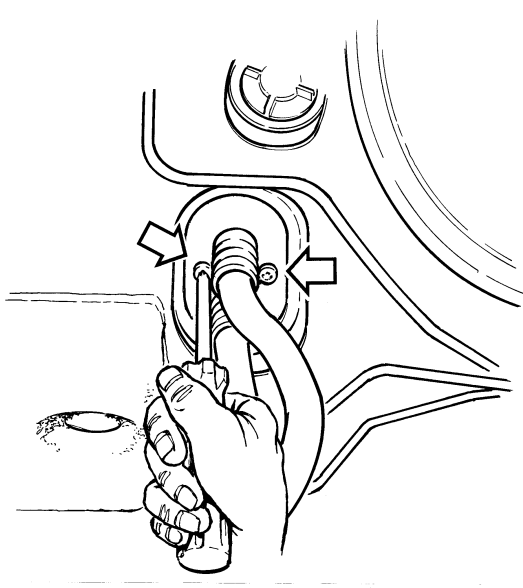

Installing

Install:

- Heater unit in cover (4 screws).
- Heater unit with cover in climate control unit (4 screws). Make sure the pipe is correctly located.
- **Note! Install new O-rings.**
- Pipe flange (1 screw).
- Drain hose
- Disconnect hoses.
- Top up coolant if required and test for leaks
- Install: Booster/amplifier bracket, booster/amplifier.
- Install: Carpet support plates.