

## Fan motor, replacement

### Removal

- Remove passenger side sound wall (3 screws)
- Remove glove compartment (4 screws).
- Remove glove compartment panel (4 screws).

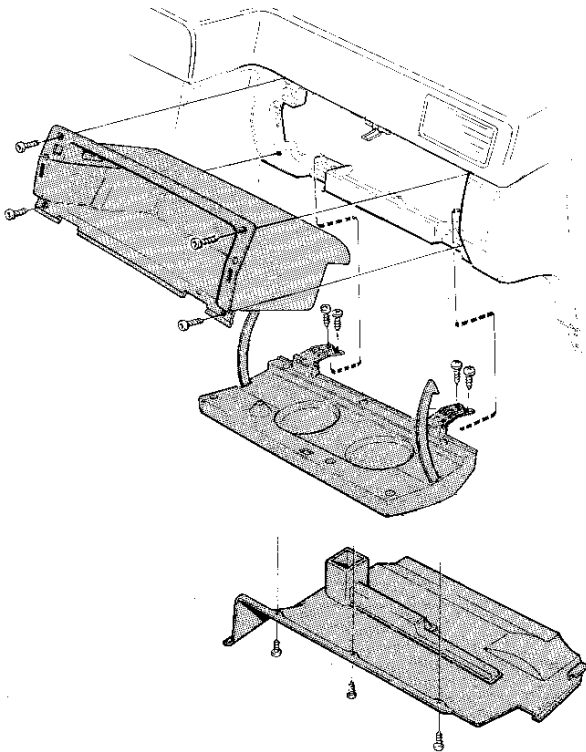

**G3**

- Disconnect fan motor connector (G3).
- Remove cable duct from fan motor.
- Remove the two connectors from their brackets.
- Remove fan motor (4 screws).

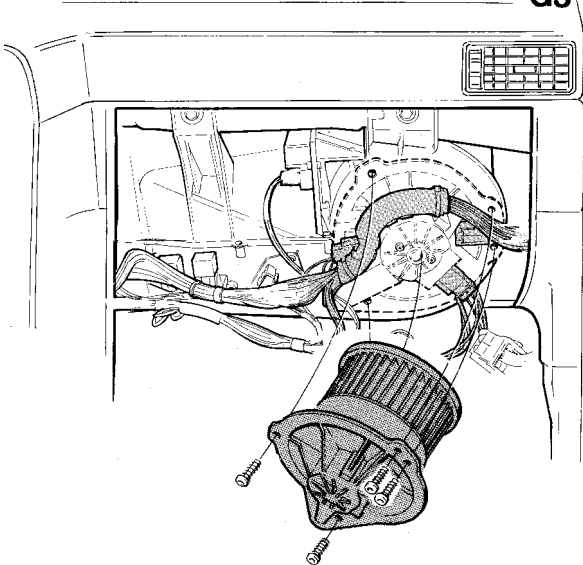

### Installation

Install:

- Fan motor.
- Connectors (2) in brackets.
- Cable duct.
- Fan motor connector.
- Glove compartment panel.
- Glove compartment.
- Sound wall.