

Handbrake, brake shoes, replacing

Removal

Remove the panel covering the handbrake lever

See [Replacing the parking brake lever](#)

Release the handbrake adjuster

Slacken off the adjustment screw 5–10 turns so that the brake disc can be removed.

Remove the rear wheels

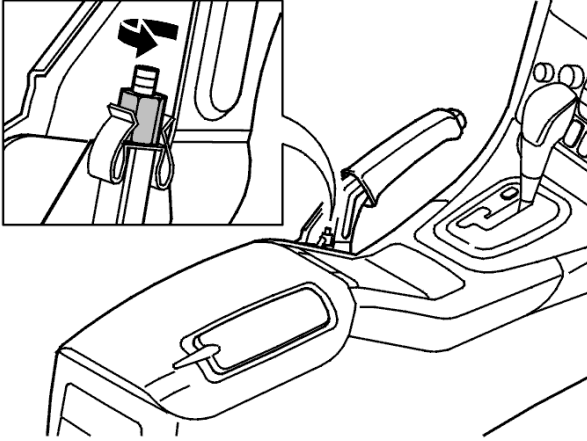

Remove the brake calliper and holder

Hang the brake calliper from the spring using a wire.

Note! Do not damage the ABS line.

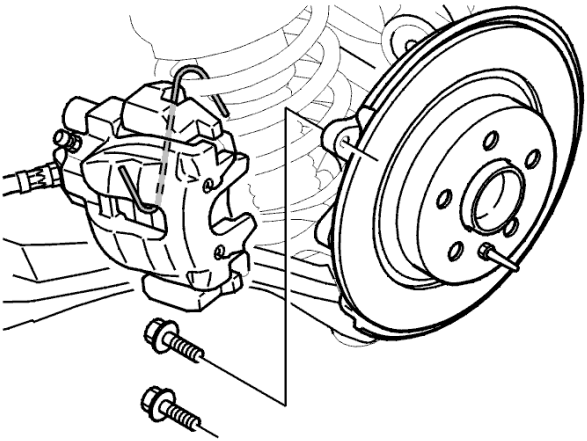

Remove the brake disc

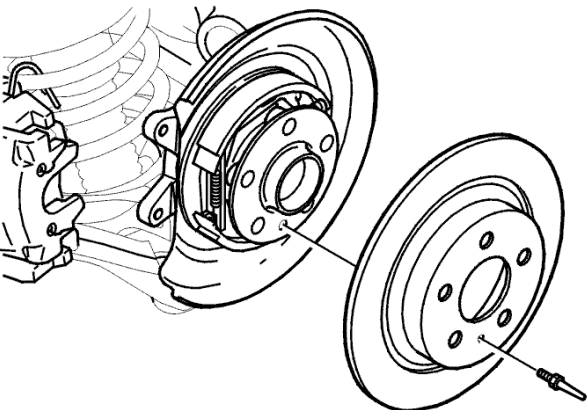

Remove the brake shoes

Remove the two securing springs on the brake shoes. Press in the springs (1) and turn them slightly (less than 1/4 turn).

Pull out the springs (2).

Detach the return spring at the expander.

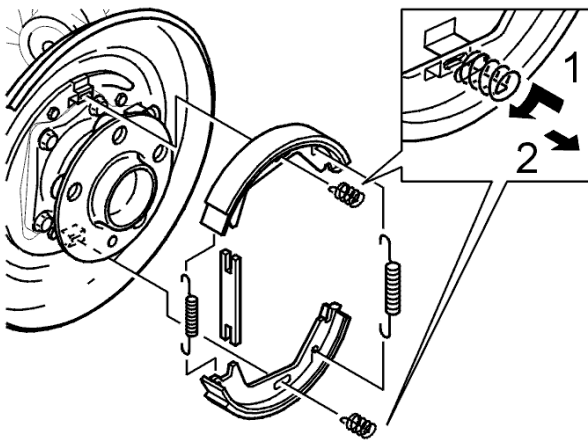

Bend the brake shoes apart and remove them with the return spring and spacer.

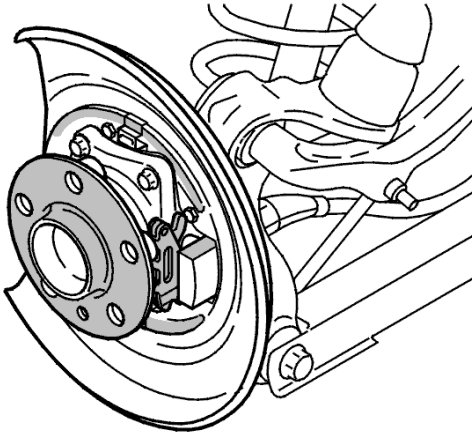

Cleaning and checking

Check that no grease has leaked out of the wheel hub. Check the handbrake expander for damage. Lubricate if necessary.

Clean the surfaces of the brake drum where the brake shoes make contact.

Check that hub flange is clean. Remove any rust.

Lubricate the contact surfaces on the brake shield. Use heat resistant grease, P/N 1161325-4.

Installation

Install the brake components

Install:

- the brake shoes
- the spacer and the small return spring on the brake shoes.

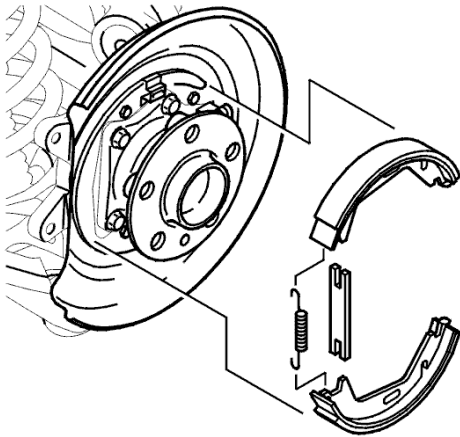

Installation brake components, continued

Install:

- the **lower** mounting spring. Press in the spring (1) and turn it slightly (less than 1/4 turn)
- the **upper** mounting spring. Check that the brake shoes are in the correct position in the expander
- the return spring by the expander.

Check that the mounting springs are secure.

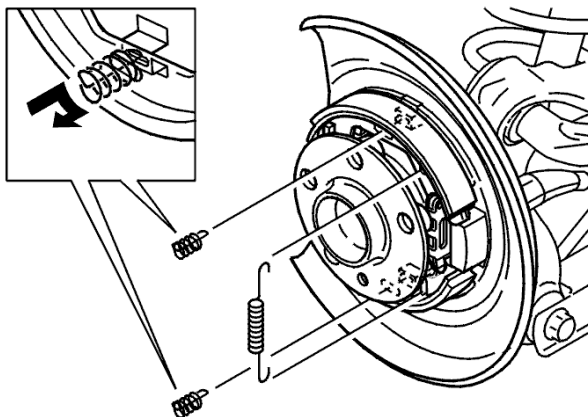

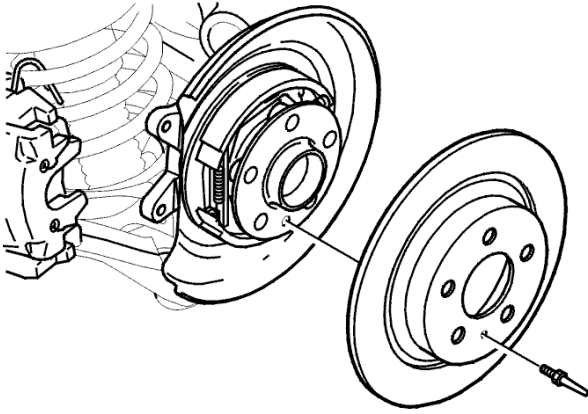

Install the brake disc and the locating pin

Tighten locating pin. Tighten to **8 Nm**.

Check the brake pads. Replace if necessary

See [Brake pads, rear, replacing](#)

Install the calliper holder and the brake calliper

Press the brake pads in the calliper apart. Install the calliper holder and the brake calliper.

Tighten the calliper holder mounting screws. Tighten to **60 Nm**.

Note! Use new screws.

Install the wheel

See [Installing wheels](#)

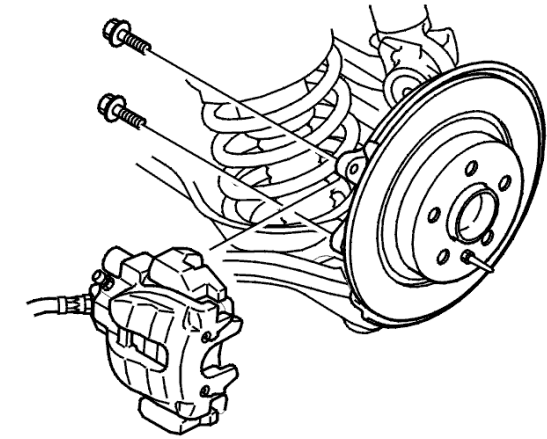

Adjust the handbrake

The handbrake lever must be in its lowest position.

Full effect can be obtained between the second and fifth ratchet teeth.

Caution! Follow the adjustment instructions to obtain full handbrake effect.

Turn the adjustment screw so that full braking effect is achieved between the second and the fifth notch.

Final check

Check that the wheels rotate freely after adjustment.

Test drive and readjust the handbrake

After replacing the brake shoes:

Drive the car at 30 km/h. Apply the handbrake lever until the car stops. This allows the brake shoes to bed into the brake drum.

Adjust the handbrake as required.

Install the panel over the handbrake lever

See [Replacing the parking brake lever](#)

